

# MBR1020VL

## Surface Mount Schottky Power Rectifier

### Features

- Ultra Thin Profile – Maximum Height of 1.08 mm
- High Surge Capacity
- UL Flammability 94V-0 Classification
- MSL 1
- Green Mold Compound
- These Devices are Pb-Free, Halogen Free and are RoHS Compliant

### Specifications

**ABSOLUTE MAXIMUM RATINGS** ( $T_A = 25^\circ\text{C}$  unless otherwise noted)

| Symbol      | Parameter                                                                                                      | Value       | Unit             |
|-------------|----------------------------------------------------------------------------------------------------------------|-------------|------------------|
| $V_{RRM}$   | Peak Repetitive Reverse Voltage                                                                                | 20          | V                |
| $I_{F(AV)}$ | Average Rectified Forward Current                                                                              | 1.0         | A                |
| $I_{FSM}$   | Non-Repetitive Peak Surge Current:<br>Surge Applied at Rated Load Conditions,<br>Half Wave, Single Phase, 60Hz | 45          | A                |
| dv/dt       | Voltage Rate of Change                                                                                         | 1000        | V/ $\mu\text{s}$ |
| $T_J$       | Operating Junction Temperature Range                                                                           | -55 to +125 | $^\circ\text{C}$ |
| $T_{STG}$   | Storage Temperature Range                                                                                      | -55 to +125 | $^\circ\text{C}$ |

Stresses exceeding those listed in the Maximum Ratings table may damage the device. If any of these limits are exceeded, device functionality should not be assumed, damage may occur and reliability may be affected.



**ON Semiconductor®**

[www.onsemi.com](http://www.onsemi.com)

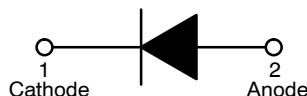

Schottky Power Rectifier

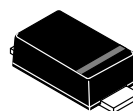

SOD-123F  
CASE 425AD

### MARKING DIAGRAM



Band Indicates Cathode

&Y = Binary Calendar Year Coding Scheme  
&Z = Assembly Plant Code  
RL = Specific Device Code  
&G = Single Digit Weekly Data Code

### ORDERING INFORMATION

See detailed ordering and shipping information on page 2 of this data sheet.

# MBR1020VL

## THERMAL CHARACTERISTICS ( $T_A = 25^\circ\text{C}$ unless otherwise noted)

| Symbol          | Characteristic                                             | Value | Unit               |
|-----------------|------------------------------------------------------------|-------|--------------------|
| $R_{\theta JA}$ | Typical Thermal Resistance, Junction-to-Ambient (Note 1)   | 200   | $^\circ\text{C/W}$ |
| $\Psi_{JL}$     | Typical Thermal Characteristics, Junction-to-Lead (Note 2) | 70    | $^\circ\text{C/W}$ |

1. Mounted with minimum recommended pad size, PC board FR4.
2. Mounted on a FR4 PCB, single-sided copper, with 10 cm \* 10 cm copper pad area.

## ELECTRICAL CHARACTERISTICS ( $T_A = 25^\circ\text{C}$ unless otherwise noted)

| Symbol   | Parameter                                                  | Conditions                                                       | Min | Typ  | Max   | Unit |
|----------|------------------------------------------------------------|------------------------------------------------------------------|-----|------|-------|------|
| $V_F$    | Instantaneous Forward Voltage (Note 3)                     | $I_F = 0.1\text{ A}$                                             | –   | –    | 0.275 | V    |
|          |                                                            | $I_F = 0.1\text{ A}, T_A = 85^\circ\text{C}$                     | –   | –    | 0.205 |      |
|          |                                                            | $I_F = 0.5\text{ A}$                                             | –   | –    | 0.315 |      |
|          |                                                            | $I_F = 0.5\text{ A}, T_A = 85^\circ\text{C}$                     | –   | –    | 0.270 |      |
|          |                                                            | $I_F = 1.0\text{ A}$                                             | –   | –    | 0.340 |      |
|          |                                                            | $I_F = 1.0\text{ A}, T_A = 85^\circ\text{C}$                     | –   | –    | 0.300 |      |
| $I_R$    | Instantaneous Reverse Current at Rated DC Voltage (Note 3) | $T_A = 25^\circ\text{C}$                                         | –   | –    | 0.60  | mA   |
|          |                                                            | $T_A = 85^\circ\text{C}$                                         | –   | –    | 15    |      |
| $T_{rr}$ | Reverse Recovery Time                                      | $I_F = 0.5\text{ A}, I_R = 1.0\text{ A}, I_{rr} = 0.25\text{ A}$ | –   | 12.4 | –     | ns   |

Product parametric performance is indicated in the Electrical Characteristics for the listed test conditions, unless otherwise noted. Product performance may not be indicated by the Electrical Characteristics if operated under different conditions.

3. Pulse test: pulse width = 300  $\mu\text{s}$ , duty cycle < 2%

## ORDERING INFORMATION

| Part Number | Top Mark | Package                            | Shipping <sup>†</sup> |
|-------------|----------|------------------------------------|-----------------------|
| MBR1020VL   | RL       | SOD-123F<br>(Pb-Free/Halogen Free) | 3000 / Tape & Reel    |

<sup>†</sup>For information on tape and reel specifications, including part orientation and tape sizes, please refer to our Tape and Reel Packaging Specifications Brochure, BRD8011/D.

TYPICAL PERFORMANCE CHARACTERISTICS

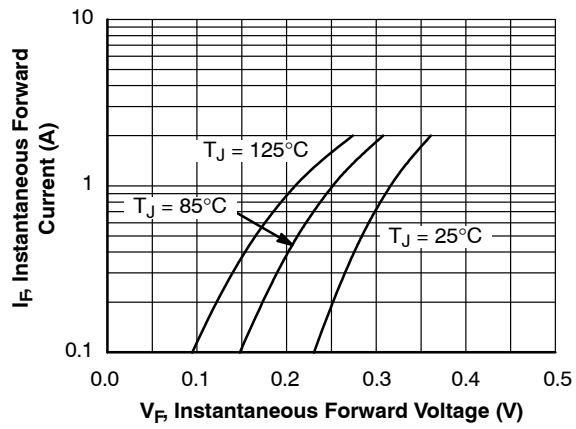

Figure 1. Typical Forward Characteristics

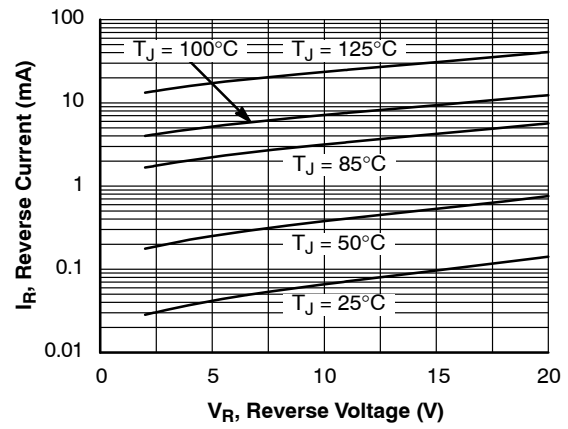

Figure 2. Typical Reverse Characteristics

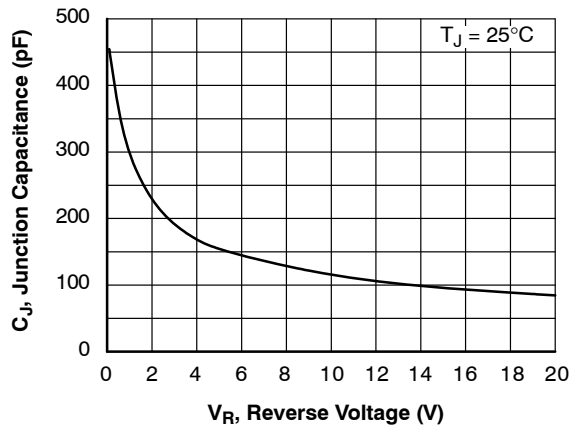
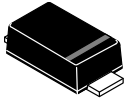

Figure 3. Capacitance



SCALE 4:1

**SOD-123FL**  
**CASE 425AD**  
**ISSUE A**

DATE 04 AUG 2017

**NOTES:**

- A. NO INDUSTRY STANDARD APPLIES TO THIS PACKAGE
- B. ALL DIMENSIONS ARE IN MILLIMETERS
- C. DIMENSIONS ARE EXCLUSIVE OF BURRS, MOLD FLASH AND TIE BAR PROTRUSIONS.

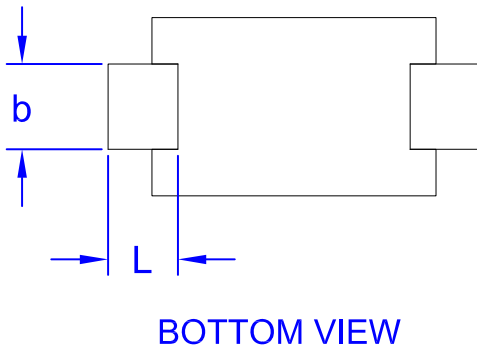
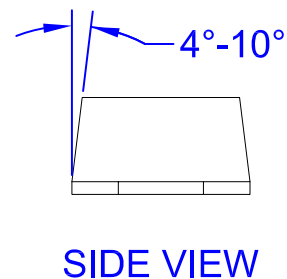
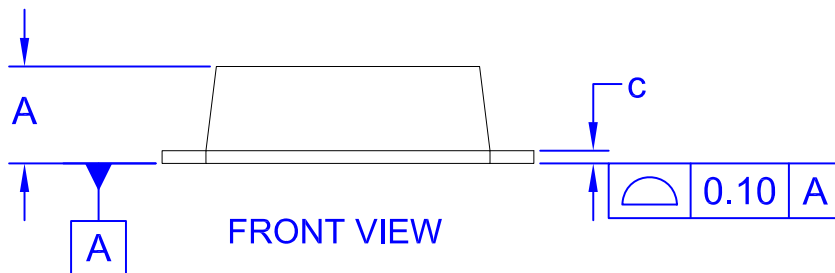
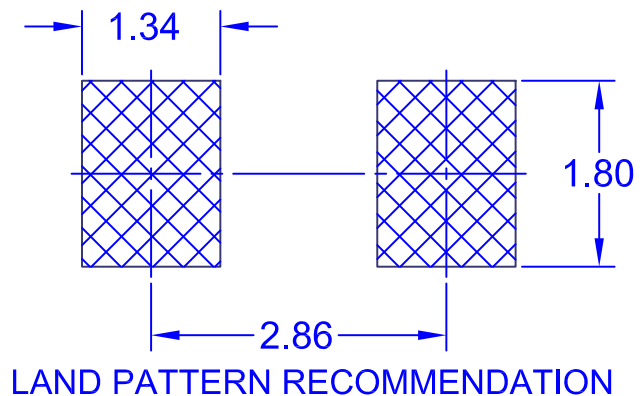
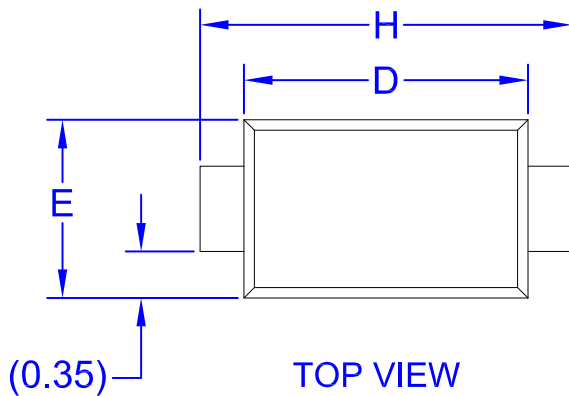

| DIM | INCHES |       | MILLIMETERS |      |
|-----|--------|-------|-------------|------|
|     | MIN    | MAX   | MIN         | MAX  |
| A   | 0.031  | 0.043 | 0.80        | 1.08 |
| b   | 0.020  | 0.045 | 0.50        | 1.15 |
| c   | 0.002  | 0.008 | 0.05        | 0.20 |
| D   | 0.098  | 0.118 | 2.50        | 3.00 |
| E   | 0.059  | 0.077 | 1.50        | 1.95 |
| H   | 0.130  | 0.154 | 3.30        | 3.90 |
| L   | 0.018  | 0.035 | 0.45        | 0.90 |

|                         |                    |                                                                                                                                                                                     |
|-------------------------|--------------------|-------------------------------------------------------------------------------------------------------------------------------------------------------------------------------------|
| <b>DOCUMENT NUMBER:</b> | <b>98AON13725G</b> | Electronic versions are uncontrolled except when accessed directly from the Document Repository.<br>Printed versions are uncontrolled except when stamped "CONTROLLED COPY" in red. |
| <b>DESCRIPTION:</b>     | <b>SOD-123FL</b>   | <b>PAGE 1 OF 1</b>                                                                                                                                                                  |

onsemi and Onsemi are trademarks of Semiconductor Components Industries, LLC dba onsemi or its subsidiaries in the United States and/or other countries. onsemi reserves the right to make changes without further notice to any products herein. onsemi makes no warranty, representation or guarantee regarding the suitability of its products for any particular purpose, nor does onsemi assume any liability arising out of the application or use of any product or circuit, and specifically disclaims any and all liability, including without limitation special, consequential or incidental damages. onsemi does not convey any license under its patent rights nor the rights of others.

**onsemi**, **Onsemi**, and other names, marks, and brands are registered and/or common law trademarks of Semiconductor Components Industries, LLC dba "**onsemi**" or its affiliates and/or subsidiaries in the United States and/or other countries. **onsemi** owns the rights to a number of patents, trademarks, copyrights, trade secrets, and other intellectual property. A listing of **onsemi**'s product/patent coverage may be accessed at [www.onsemi.com/site/pdf/Patent-Marking.pdf](http://www.onsemi.com/site/pdf/Patent-Marking.pdf). **onsemi** reserves the right to make changes at any time to any products or information herein, without notice. The information herein is provided "as-is" and **onsemi** makes no warranty, representation or guarantee regarding the accuracy of the information, product features, availability, functionality, or suitability of its products for any particular purpose, nor does **onsemi** assume any liability arising out of the application or use of any product or circuit, and specifically disclaims any and all liability, including without limitation special, consequential or incidental damages. Buyer is responsible for its products and applications using **onsemi** products, including compliance with all laws, regulations and safety requirements or standards, regardless of any support or applications information provided by **onsemi**. "Typical" parameters which may be provided in **onsemi** data sheets and/or specifications can and do vary in different applications and actual performance may vary over time. All operating parameters, including "Typicals" must be validated for each customer application by customer's technical experts. **onsemi** does not convey any license under any of its intellectual property rights nor the rights of others. **onsemi** products are not designed, intended, or authorized for use as a critical component in life support systems or any FDA Class 3 medical devices or medical devices with a same or similar classification in a foreign jurisdiction or any devices intended for implantation in the human body. Should Buyer purchase or use **onsemi** products for any such unintended or unauthorized application, Buyer shall indemnify and hold **onsemi** and its officers, employees, subsidiaries, affiliates, and distributors harmless against all claims, costs, damages, and expenses, and reasonable attorney fees arising out of, directly or indirectly, any claim of personal injury or death associated with such unintended or unauthorized use, even if such claim alleges that **onsemi** was negligent regarding the design or manufacture of the part. **onsemi** is an Equal Opportunity/Affirmative Action Employer. This literature is subject to all applicable copyright laws and is not for resale in any manner.

## ADDITIONAL INFORMATION

### TECHNICAL PUBLICATIONS:

Technical Library: [www.onsemi.com/design/resources/technical-documentation](http://www.onsemi.com/design/resources/technical-documentation)  
onsemi Website: [www.onsemi.com](http://www.onsemi.com)

### ONLINE SUPPORT: [www.onsemi.com/support](http://www.onsemi.com/support)

For additional information, please contact your local Sales Representative at  
[www.onsemi.com/support/sales](http://www.onsemi.com/support/sales)