

DIP26 67.8x40
CASE 181AD
ISSUE B

DATE 05 AUG 2021

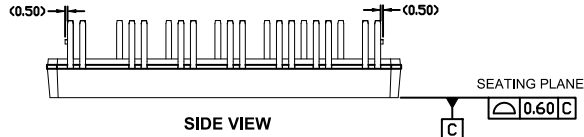

SIDE VIEW

NOTES:

1. Dimensioning and tolerancing as per ASME Y14.5M, 2009
2. Controlling Dimension: Millimeters
3. Dimensions are exclusive of Burrs, Mold Flash, and Tiebar extrusions
4. Dimensions "b" and "c" apply to plated leads
5. Position of the leads is determined at the root of the lead where it exits the package body

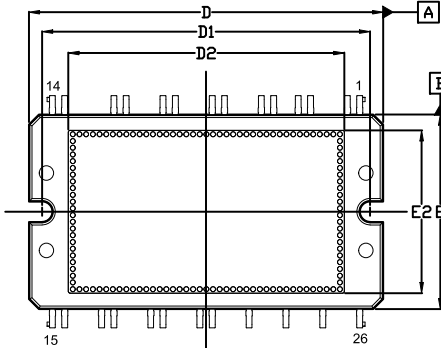

TOP VIEW

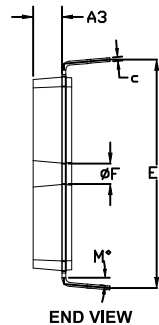

END VIEW

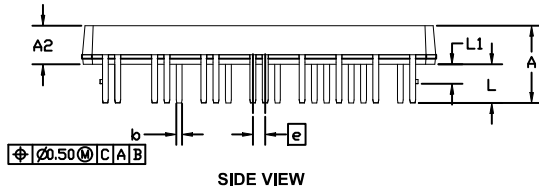

SIDE VIEW

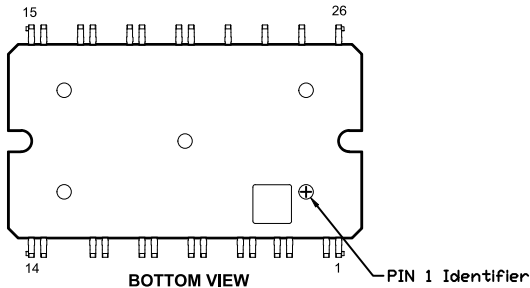

BOTTOM VIEW

PIN 1 Identifier

| DIM | MILLIMETERS | | |
|-----|-------------|-------|-------|
| | MIN | NOM | MAX |
| A | 15.50 | 16.00 | 16.50 |
| A2 | 7.80 | 8.00 | 8.20 |
| A3 | 6.00 REF | | |
| b | 1.10 | 1.20 | 1.30 |
| c | 0.70 | 0.80 | 0.90 |
| D | 72.70 | 73.20 | 73.70 |
| D1 | 67.30 | 67.80 | 68.30 |
| D2 | 57.30 REF | | |
| E | 39.70 | 40.20 | 40.70 |
| E1 | 46.70 | 47.20 | 47.70 |
| E2 | 33.87 REF | | |
| e | 2.54 BSC | | |
| F | 4.00 | 4.20 | 4.40 |
| L | 8.00 REF | | |
| L1 | 3.50 | 4.00 | 4.50 |
| M | 4° | 5° | 6° |

GENERIC MARKING DIAGRAM*

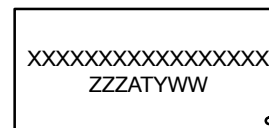

XXX = Specific Device Code
ZZZ = Assembly Lot Code
AT = Assembly & Test Location
Y = Year
WW = Work Week

*This information is generic. Please refer to device data sheet for actual part marking. Pb-Free indicator, "G" or microdot "▪", may or may not be present. Some products may not follow the Generic Marking.

| | | |
|-------------------------|----------------------|--|
| DOCUMENT NUMBER: | 98AON09519H | Electronic versions are uncontrolled except when accessed directly from the Document Repository. Printed versions are uncontrolled except when stamped "CONTROLLED COPY" in red. |
| DESCRIPTION: | DIP26 67.8x40 | PAGE 1 OF 1 |

onsemi and onsemi are trademarks of Semiconductor Components Industries, LLC dba onsemi or its subsidiaries in the United States and/or other countries. onsemi reserves the right to make changes without further notice to any products herein. onsemi makes no warranty, representation or guarantee regarding the suitability of its products for any particular purpose, nor does onsemi assume any liability arising out of the application or use of any product or circuit, and specifically disclaims any and all liability, including without limitation special, consequential or incidental damages. onsemi does not convey any license under its patent rights nor the rights of others.